

Label Rewinders which are your best choice. You can own one easy operation & economic and durable label rewinder, No need manual rewind when printing, Resolve trivial manual rewinding process, Reduce labour intensity, Improve label printing quality (labels stick dust easily or destroy if not rewind on time). It can help enterprises save labor cost, Promote working efficiency, Improve enterprise image, it is the good helper for the labeling personnel, Also it is the good partner for the boss.

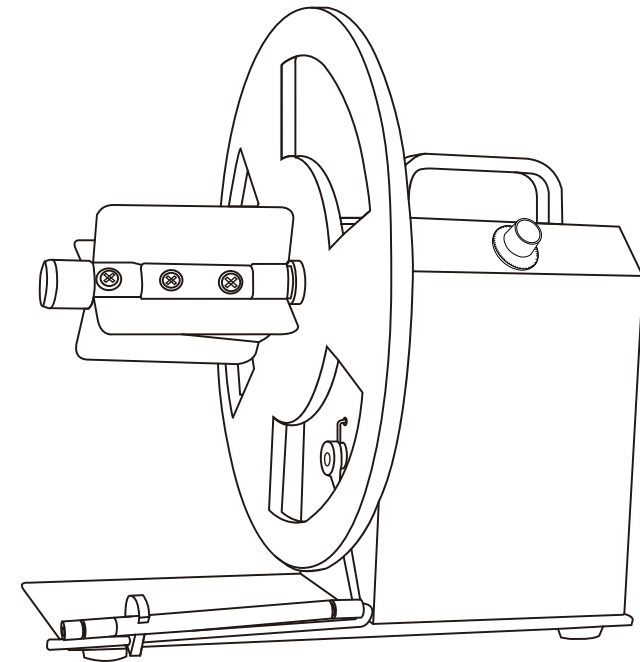

BS-Q 120 Label Rewinder Installation & Operating Instructions





BS-Q120 Label Rewinder Installation Diagram

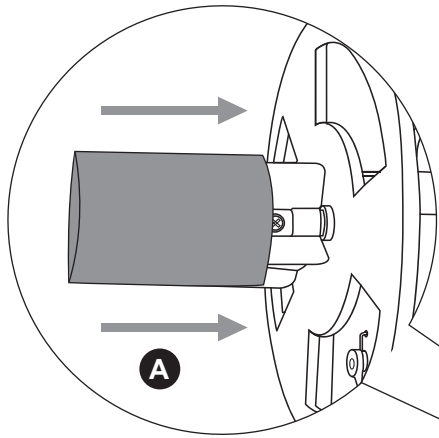

- 1** A. Insert label paper core into 1" (25.4mm)/1.5 (40mm) / 3 (76mm) rewind reel as arrow direction.

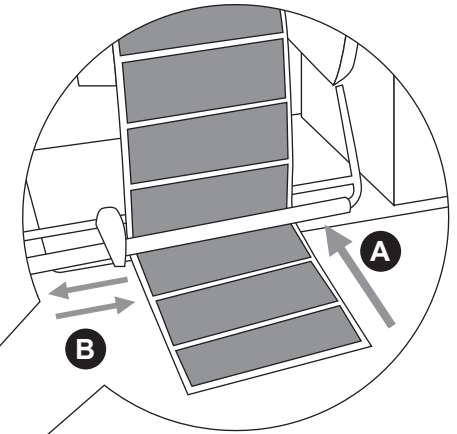

- 3** A. Pass the labels that needs to be recycled through the middle of the double pull rod of the rewinder.
B. Move paper ring of the double pull rod to the right width of the label. (Paper Ring Function: Prevent label displacement in the process of rewinding)

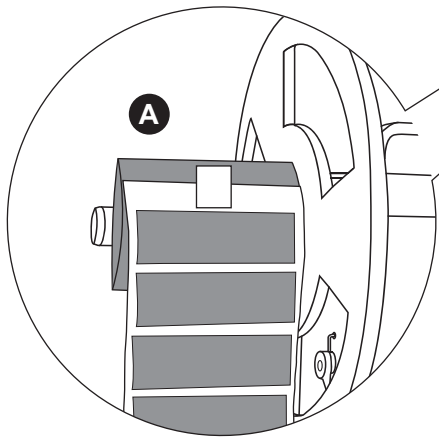

- 2** A. Stick the end of the label on the paper core and fix it.

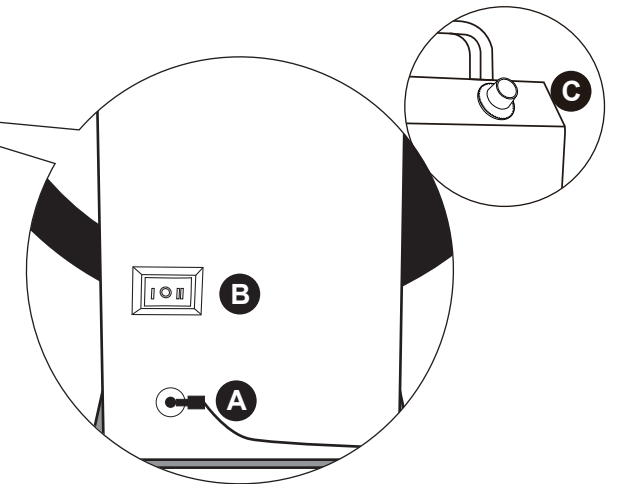
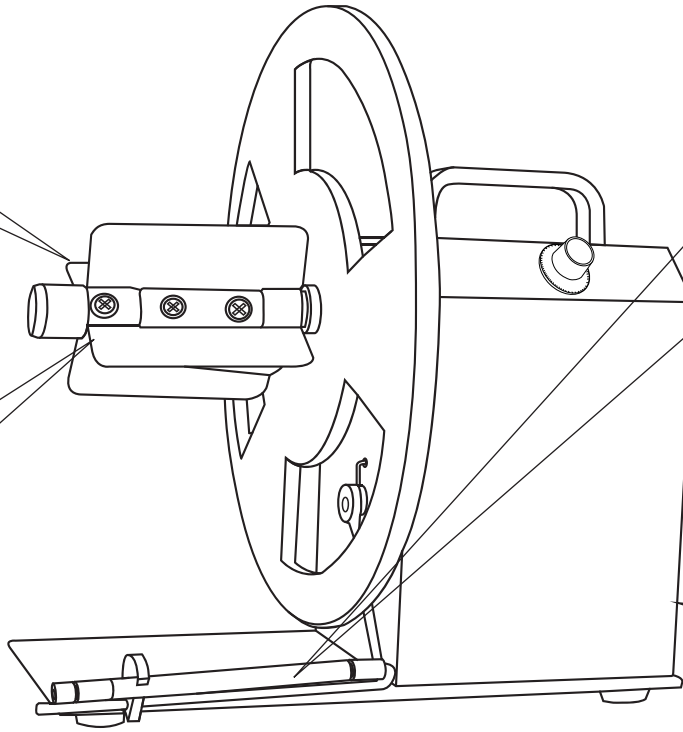

- 4** A. Connect the power supply.
B. Turn on the power switch.
C. Adjust the speed. Start automatic synchronous rollback.